

WORCESTER COUNTY LAYOUT(S)
OF BRIMSBURY STREET

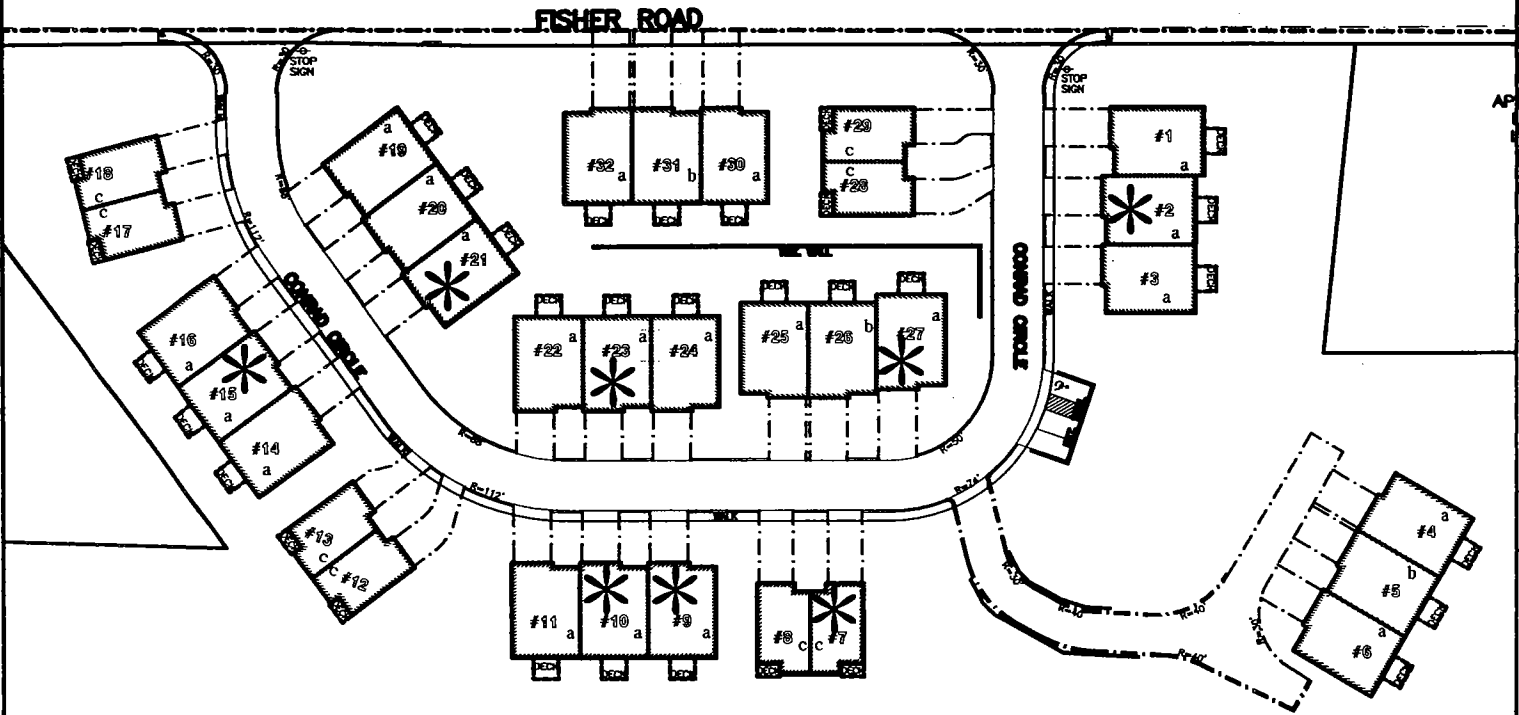

THE UNITS DESIGNATED BY *
ARE OFFERED AS A SUGGESTION AS THOSE UNITS
TO BE CLASSIFIED BY THE ZONING BOARD OF
APPEALS AS AFFORDABLE UNIT DISTRIBUTION.

JOB NO.
134-1446/2095

DATE:
APRIL 14, 2006

SCALE:
NONE

THOMPSON-LISTON
ASSOCIATES, INC.

Professional Engineers Professional Land Surveyors

51 Main Street, Post Office Box 570
Boylston, Massachusetts 01505-0570
Telephone (508) 869-6151 FAX (508) 869-6842



SUGGESTED AFFORDABLE UNIT DISTRIBUTION

FISHER TERRACE
FISHER ROAD
HOLDEN, MASSACHUSETTS

DRAWING NO.

SK-1